

SLOUGH MULTIFUEL EXTENSION PROJECT

[PINS Ref: EN010129]

Drawings and Plans

Habitats of Protected Species Plan

Application Document Reference: [4.6]

APFP Regulations 5(2)(i)

Revision Number: 1.0

Planning Act 2008
Infrastructure Planning (Applications: Prescribed
Forms and Procedure) Regulations 2009

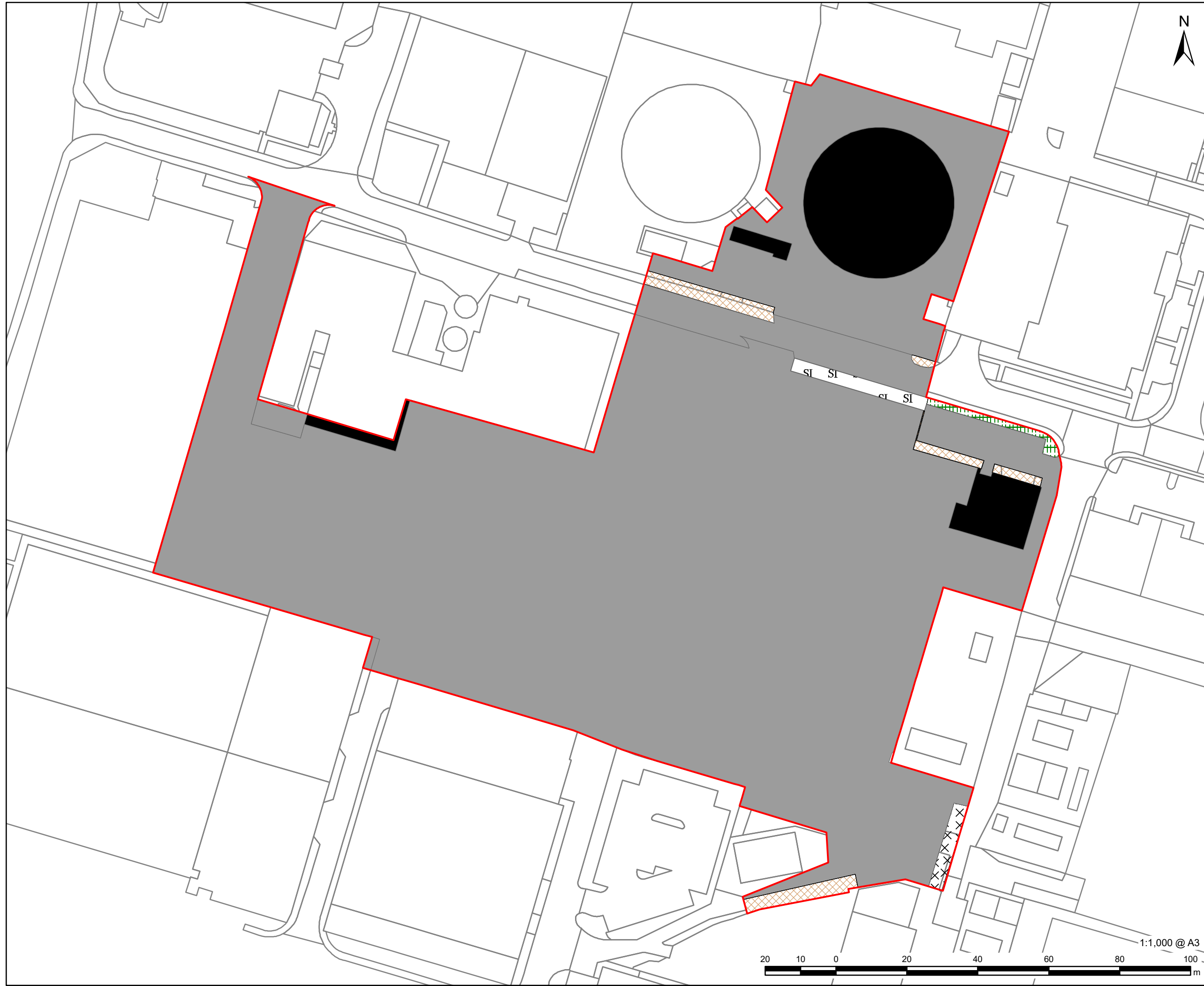

SSE Slough Multifuel

3rd Floor, Portwall Place
Portwall Lane
Bristol
BS1 6NA
aecom.com

- Proposed Project Site Boundary
- Phase 1 Habitat**
- SI B6 - Poor semi-improved grassland
- Hardstanding
- X X J1.3 - Cultivated/disturbed land - ephemeral/short perennial
- J1.4 - Introduced shrub
- |||| J2.3.2 - Hedge with trees - species-poor
- J3.6 - Buildings

Reproduced from Ordnance Survey digital map data © Crown copyright [2022]. All rights reserved. Licence number 0100031673.

Environmental Statement
APFP Regulation 5(2)(l)(ii)

EN010129

Habitats of Protected Species Plan

Figure 4.6

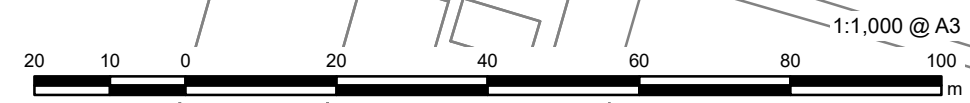

The drawing has been prepared for the use of AECOM's client. It may not be used, modified, reproduced or relied upon by third parties, except as agreed by AECOM or as required by law. AECOM accepts no responsibility, and denies any liability whatsoever, to any party that uses or relies on this drawing without AECOM's express written consent. Do not scale this document. All measurements must be obtained from the stated dimensions.